

- NOTES
1. MAXIMUM INLET FUEL PRESSURE: 90 PSIG.
 2. RECOMMENDED OPERATING TEMPERATURE -30 DEGREES F TO 300 DEGREES F.
 3. CARB LOSS AT WOT: 10 INCHES H2O AT 2000 PPH AIRFLOW WITH .0765 AIR DENSITY.

REVISIONS				
ZONE	REV	DESCRIPTION	DATE	APPROVED

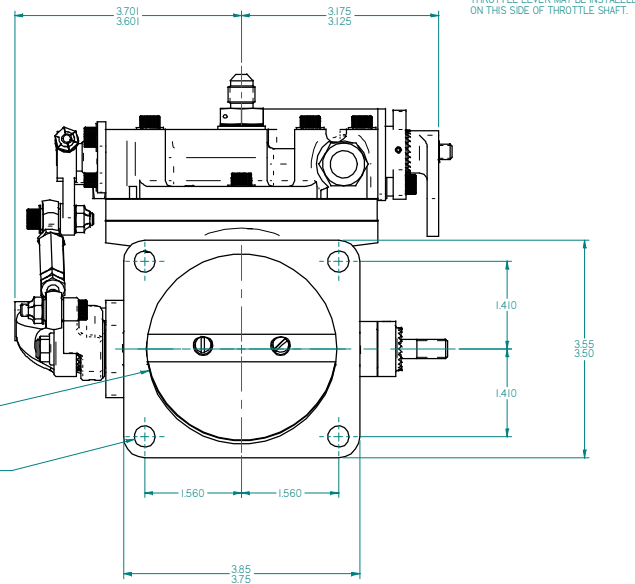
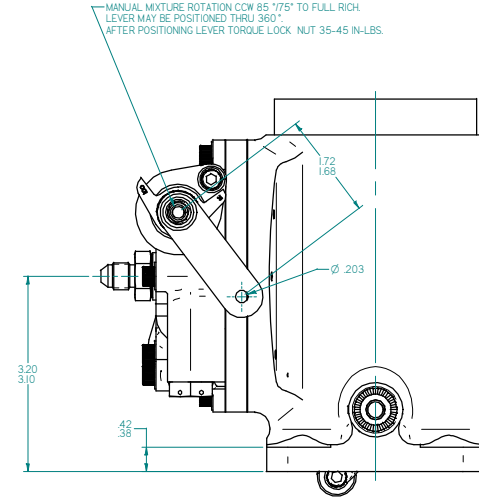
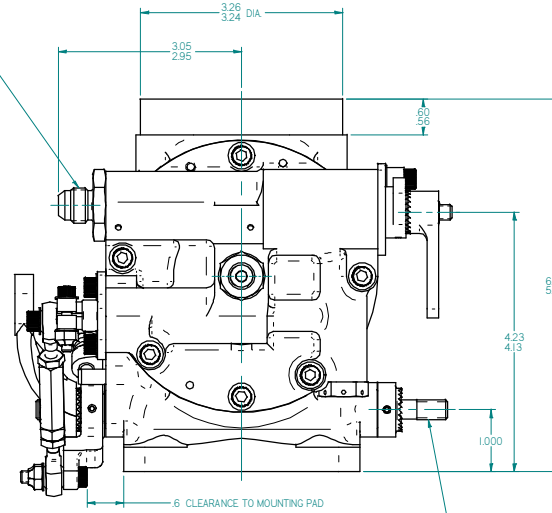
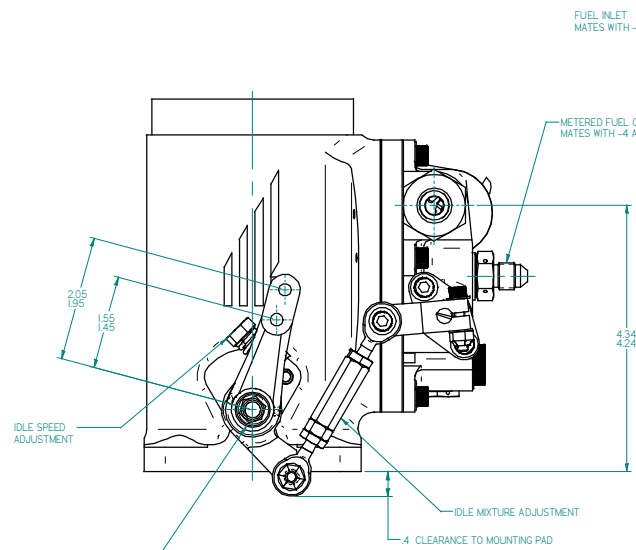

AIRFLOW PERFORMANCE, INC. CLAIMS PROPRIETARY RIGHTS IN THE INFORMATION DISCLOSED HEREON. THIS DRAWING IS FURNISHED IN CONFIDENCE ON THE EXPRESSED UNDERSTANDING THAT NEITHER IT NOR ANY REPRODUCTION THERE OF WILL BE DISCLOSED TO OTHERS OR USED FOR THE PURPOSE OF MANUFACTURE OR PROCUREMENT OF THE ARTICLE OR PART SHOWN HEREON.

PROTECTIVE COAT:		FM-200A FUEL CONTROL		
HEAT TREAT:		AIRFLOW PERFORMANCE, INC.		
MATERIAL:	SIZE D	PSICNO. 5020063	DATE: 5-10-17	REV
SCALE 1/1	DRAWN BY DJR	APPROVED BY:		